

KEY

- 1. Entrance Building
- 2. Restaurant/Café
- 3. Administration and Curatorial Building
- 4. Nocturnal Habitat
- 5. Reptile Habitat
- 6. Aquarium
- 7. Farm Experience
- 8. Picnic and Play Area
- 9. The Boulevard
- 10. Main Pedestrian Path
- 11. Kiosk
- 12. Elevated boardwalk
- 13. Water Storage
- 14. Zoo Services Facilities
- 15. Perimeter Service Road
- 16. Main carpark
- 17. Overflow carpark
- 18. Site Pond
- 19. Exhibit Water Moat
- 20. Exhibit Dry Moats
- 21. Show area

**African Grassland
(Zebra, Giraffe, Lion, Cheetah, Rhino, African Wild Dog etc)**

- 22. Back of House Buildings (open pens areas shown as outline).
- 23. African Open grasslands

**South Eastern Tropical
(Primates, Tiger, Sun Bear, Elephants)**

- 24. Back of House Buildings (open pens areas shown as outline).
- 25. South Eastern Tropical Landscape

Cumberland Plains Woodlands/Australia

- 26. Back of House Buildings
- 27. Australian Animals (Dingos, Koalas Kangaroos Platypus etc)
- 28. Ferris Wheel



KEY

--- Sydney Zoo Scope Boundary

--- South Plot Boundary (Not In Scope)



THE SHOW

ARENA

- Grassed show Arena
- Concrete or Stone Seating



THE WALK

- Grit Blasted exposed aggregate insitu.
- Aggregate Varies across Zoo.



SERVICE ROAD

- Asphalt

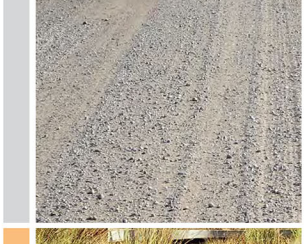

UNSEALED ROAD

- Trafficable Gravel

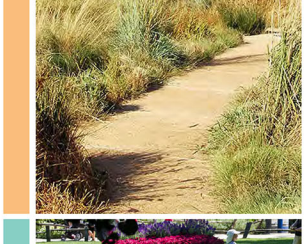

CRUSHED SANDSTONE

PATHWAY



PICNIC GREEN

- High traffic suited species of turf with engineered sub grade to ensure longevity and success.
- King's Pride' Soft Leaf Buffalo

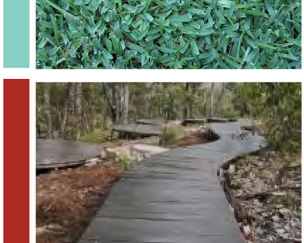

RAISED PATHS (300M)

- Timber boardwalk



Ferris Wheel
Grass Protection Mats

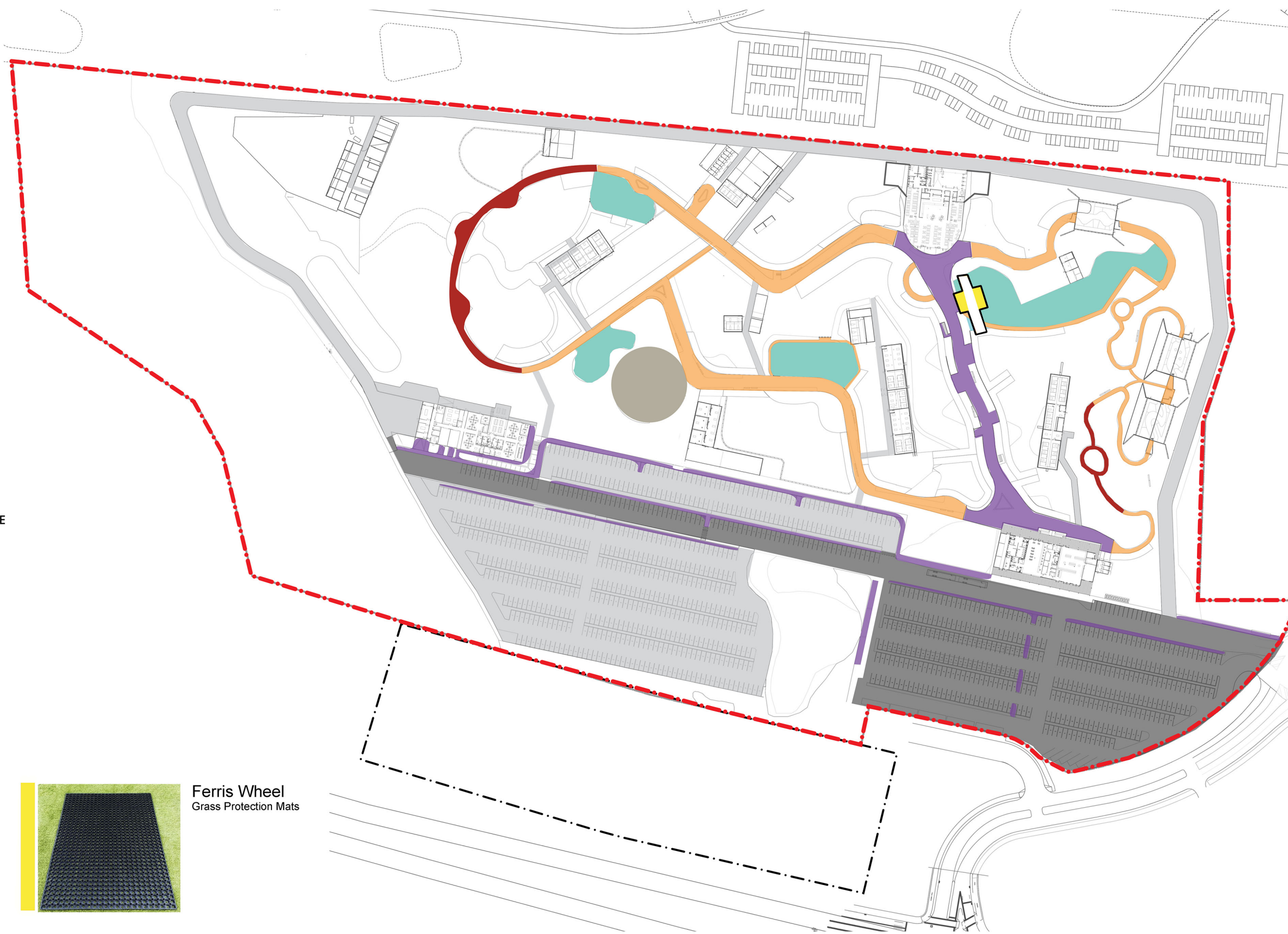

KEY

--- Sydney Zoo Scope Boundary

- - - South Plot Boundary (Not In Scope)

Botanic Name	Common Name	Native/ Exotic
Trees		
<i>Acacia parramattensis</i>	Paramatta wattle	Native
<i>Brachychiton acerifolius</i>	Illawarra Flame Tree	Native
<i>Castanospermum australe</i>	Blackbean	Native
<i>Casuarina glauca</i>	Swamp Oak	Native
<i>Corymbia maculata</i>	Spotted gum	Native
<i>Cupaniopsis anacardioides</i>	Tuckeroo	Native
<i>Eucalyptus amplifolia</i>	Cabbage gum	Native
<i>Eucalyptus eugenioides</i>	Thin leaved stringybark	Native
<i>Eucalyptus fibrosa</i>	Broad leaved Red Ironbark	Native
<i>Eucalyptus tereticornis</i>	Forest Red Gum	Native
<i>Flindersia australis</i>	Crows Ash	Native
<i>Harpullia pendula</i>	Tulipwood	Native
<i>Hakea sericea</i>	Silly hakea	Native
<i>Lophostemon confertus</i>	Brush Box	Native
<i>Melaleuca decora</i>	White feather Honey Myrtle	Native
<i>Melaleuca sieberi</i>	Sieber's Paperbark	Native
<i>Melaleuca styphelioides</i>	Prickly-leaved paperbark	Native



Botanic Name	Common Name	Native/ Exotic
Shrubs and Ground Covers		
<i>Bursaria spinosa</i>	Sweet Bursaria	Native
<i>Carex appressa</i>	Tall Sedge	Native
<i>Casuarina glauca 'Cousin It'</i>	Cousin It	Native
<i>Cheilanthes distans</i>	Bristly Cloak Fern	Native
<i>Chrysocephalum apiculatum</i>	Yellow Buttons	Native
<i>Gymnopogon refractus</i>	Barbed wire grass	Native
<i>Daviesia ulicifolia</i>	Gorse bitter pea	Native
<i>Dianella spp.</i>	Flax lily	Native
<i>Dietes robinsoniana</i>	Wedding Lily	Native
<i>Doryanthes excelsa</i>	Gynea lily	Native
<i>Ficinia nodosa</i>	Knobby Club-Rush	Native
<i>Grevillea juniperina 'Pink Lady'</i>	Pink Lady Spider Grevillea	Native
<i>Hibbertia scandens</i>	Snake Vine	Native
<i>Indigofera australis</i>	Australian Indigo	Native
<i>Lomandra filiformis</i>	Wattle mat-rush	Native
<i>Lomandra longifolia</i>	Spiry-Headed Mat Rush	Native
<i>Lomandra longifolia 'Tanika'</i>	Tanika Fine-leaved Lomandra	Native
<i>Microlaena stipoides</i>	Weeping grass	Native
<i>Pennisetum alopecuroides 'Nafray'</i>	Nafray Fountain Grass	Native
<i>Poa labillardieri 'Eskdale'</i>	Eskdale Blue Tussock Grass	Native
<i>Poa poliformis 'Kingsdale'</i>	Kingsdale Tussock Grass	Native
<i>Themedia australis</i>	Kangaroo grass	Native
<i>Callistemon</i>	Bottle Brush	Native
<i>Syzygium smithii</i>	Lilli Pilli	Native
<i>Poa Labillardieri</i>	Common Tussock Grass	Native



Botanic Name	Common Name	Quantity	Native/ Exotic
Car Park			
<i>Cupaniopsis anacardioides</i>	Tuckeroo		Native
<i>Corymbia citriodora 'scentuosus'</i>	Lemon scented gum - dwarf		Native



Sydney ZOO DA
REVISED PLANS MAY 2022

Client: Sydney Zoo



Drawn:
Checked:

Scale: 1:1000 @ A1
Date: MAY 2022

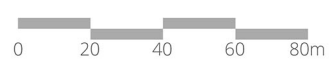

Dwg no. :L17
Rev: B

Planting Strategy- NATIVE VEGETATION